

Access Routes for Persons with Disabilities (PWDs) within the Recreation Complex

The new Recreation Complex (RC) is completely wheelchair accessible, featuring accessible pathways throughout the facility. To provide a seamless, comfortable visit for Persons with Disabilities (PwDs), we have designated accessible routes. Depending on where you are headed, specialised lifts are available to assist you in moving between levels.

Upon arrival at the RC, please check in at the security counter and inform Security Officers (SO) of your destination. You will be guided along accessible routes within the building and offered assistance.

If PWDs needs assistance to use any of the specialised lifts, they should call 6885 0660 or press the call buttons near the specialised lifts.

PWDs should check out at the security counter before departing from the Recreation Complex.

Please refer to the table below to access our facilities, and feel free to approach our SOs at the main counter if you require any assistance.

LEVEL	FACILITIES	ACCESSIBLE BY	ALTERNATIVE ACCESSIBILITY	REMARKS
1	<ul style="list-style-type: none"> ◦ Swimming Pool ◦ F&B ◦ Joy Luck Cove ◦ Game & Rec Room 	→ Ramp	Nil	Refer to Diagram A
1M	<ul style="list-style-type: none"> ◦ Network Loft 	→ Passenger Lifts PL1 or PL2 to Level 2 → Wheelchair Lift	Nil	Refer to Diagram B
2	<ul style="list-style-type: none"> ◦ Pre-Function Lobby ◦ Grand Ballroom 	→ Passenger Lifts PL1 or PL2	Nil	Refer to Diagram C
2M	<ul style="list-style-type: none"> ◦ Karaoke Lounge 	→ Passenger Lifts PL1 to Level 3 → Platform Lift	→ Passenger Lifts PL2 to Level 2 → Stair Climber*	Refer to Diagram D & D1
3	<ul style="list-style-type: none"> ◦ Heritage Gallery ◦ Lattice Suite ◦ TV/Reading Room 	→ Passenger Lifts PL1	→ Passenger Lifts PL2 to Level 2 → Stair Climber*	Refer to Diagram E & E1

*In the event PL1 is not available

DIAGRAM A (LEVEL 1)

TO SWIMMING POOL, F&B, JOY LUCK COVE AND GAME & REC ROOM

1. Take the ramp from the entrance of the Recreation Complex. You'll be able to access to all facilities at Level 1

1.

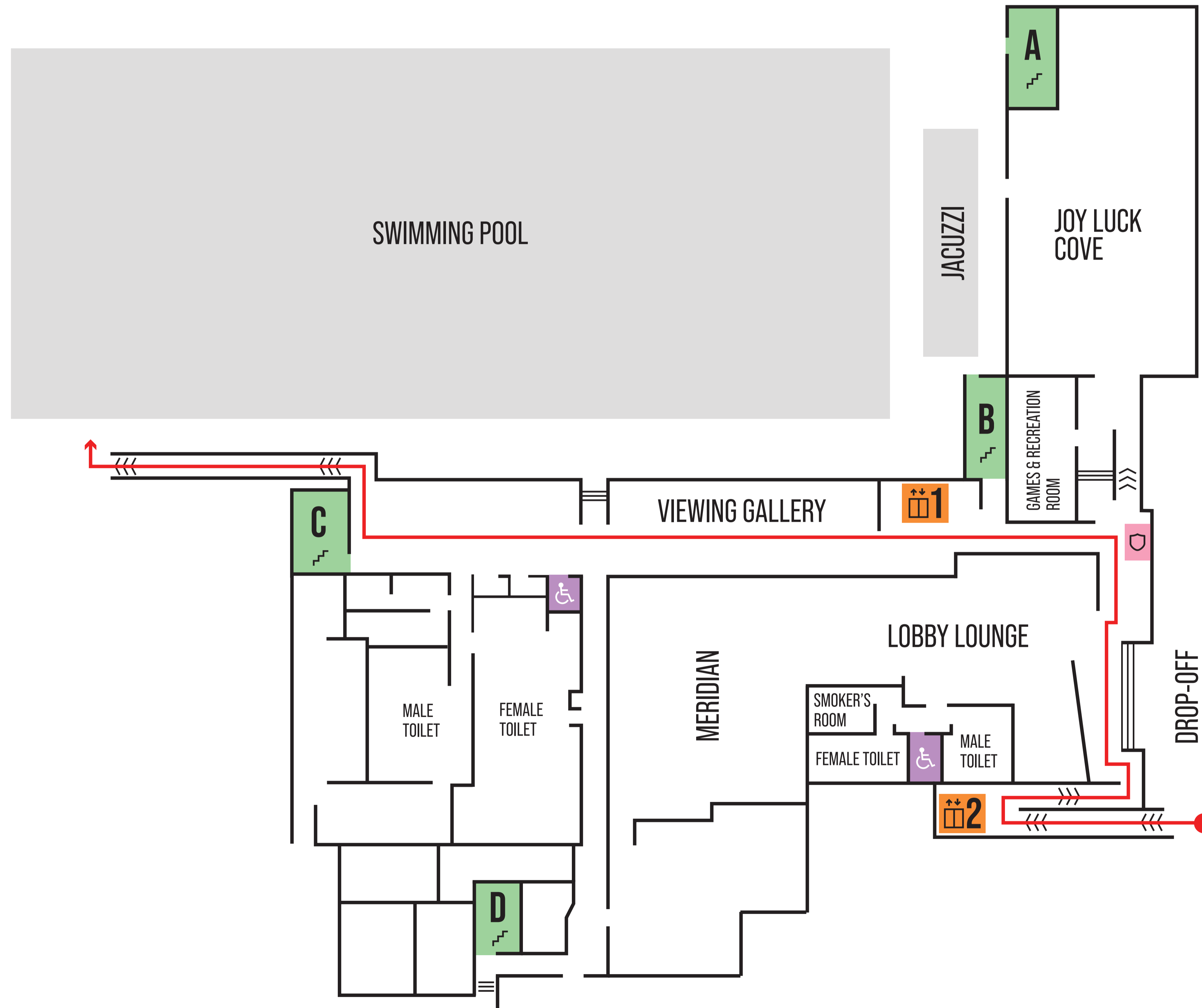

LEGEND :

ROUTE TO SWIMMING POOL



STAIRCASE



PASSENGER LIFT



SECURITY COUNTER



HANDICAP TOILET



DIAGRAM B (LEVEL 1M)

TO NETWORK LOFT

1. Take the ramp from the entrance of the Recreation Complex to passenger lift 1 or 2. Go up to level 2.
2. Enter corridor through the door on the left.
3. Head to the Wheelchair Lift  and press the call button for assistance.
4. Exit corridor and turn right.

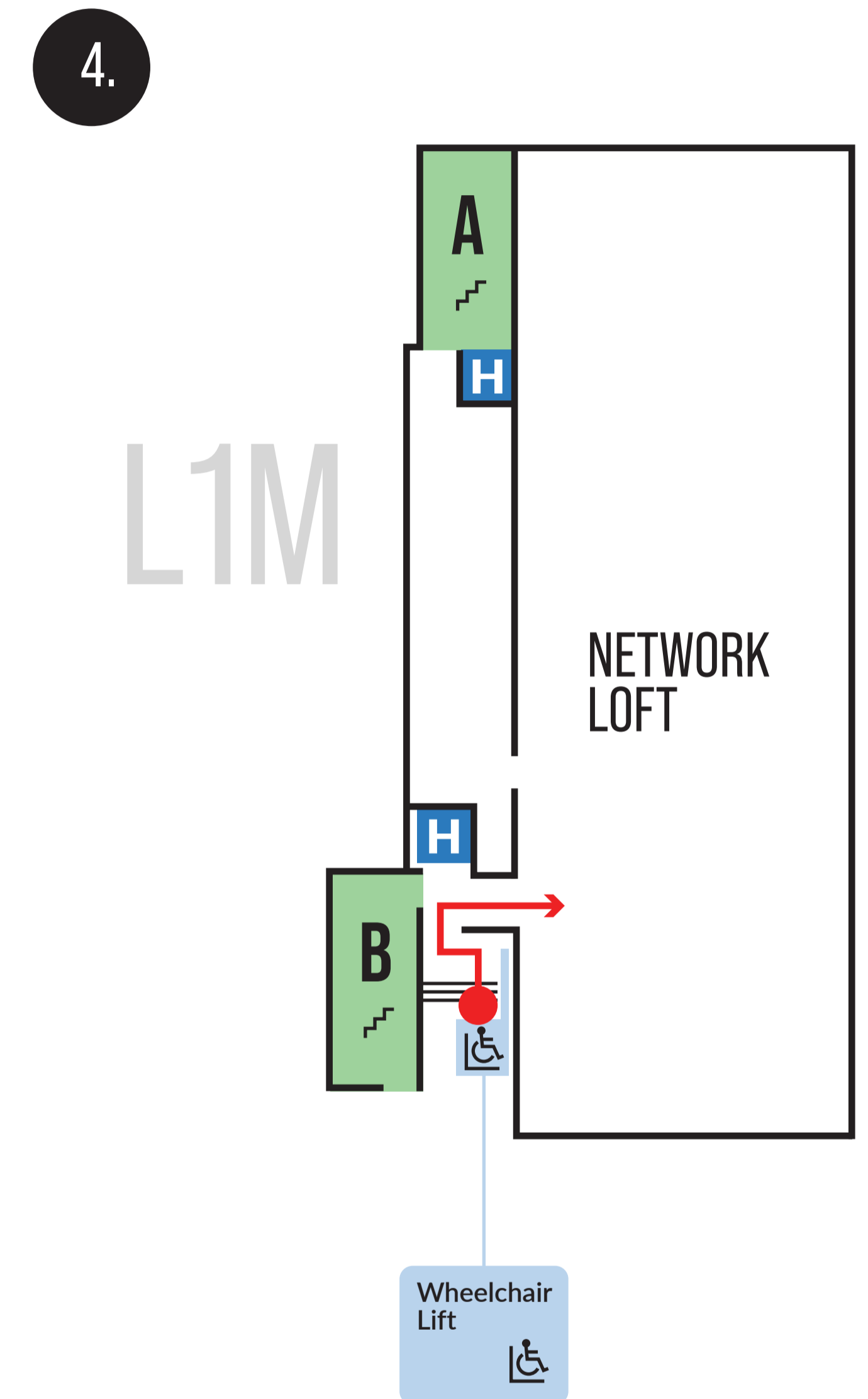
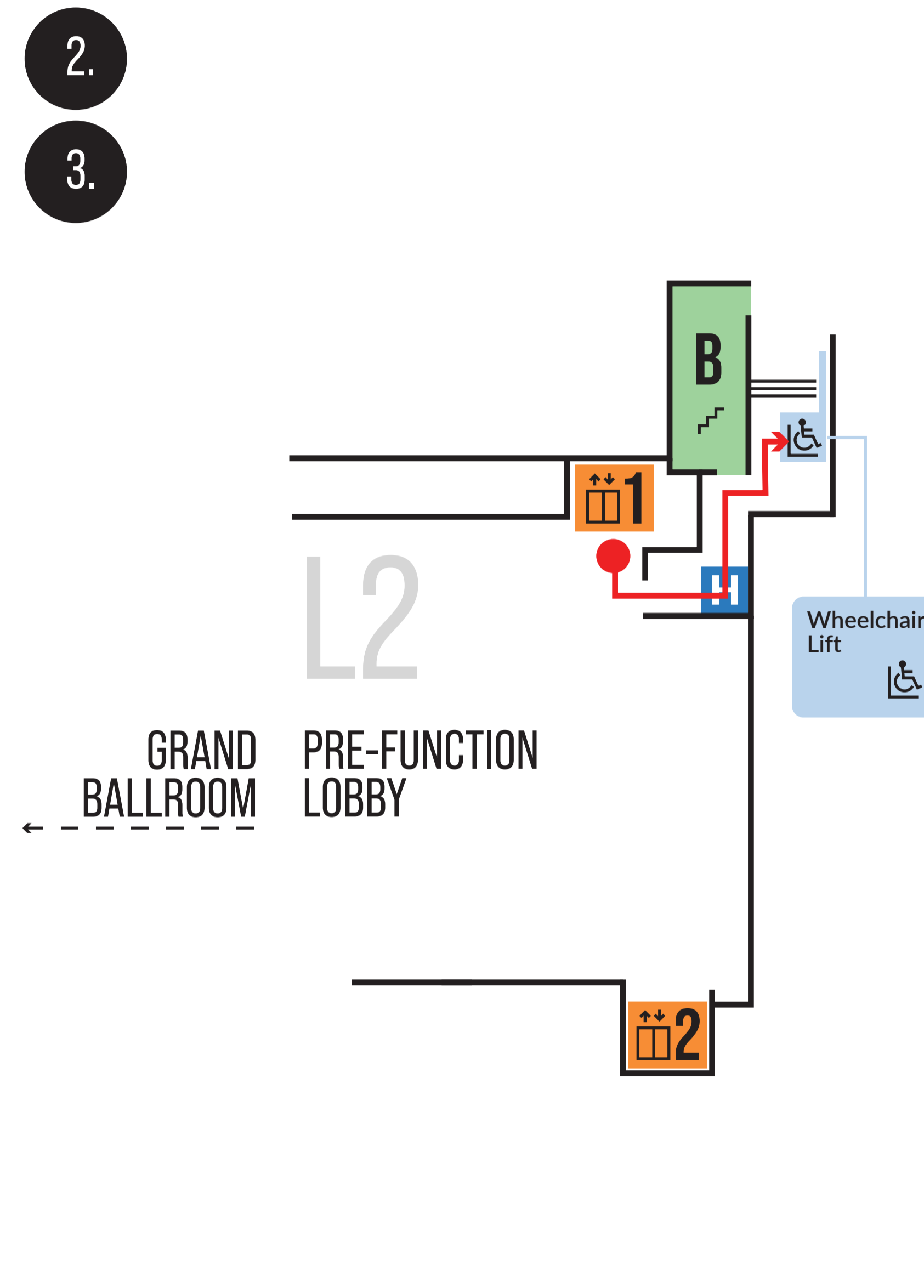
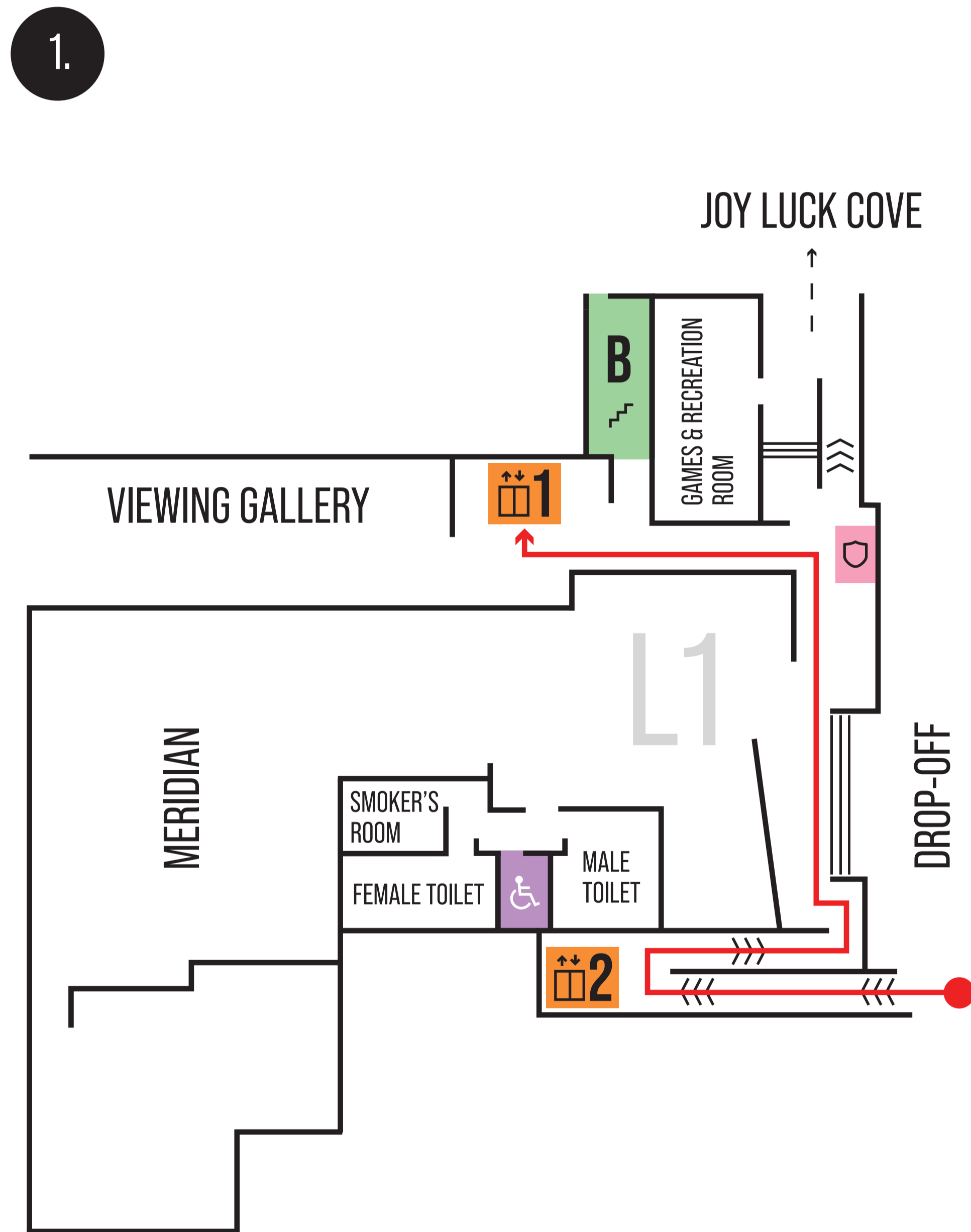

LEGEND:

ROUTE TO NETWORK LOFT



SECURITY COUNTER



WHEELCHAIR LIFT



STAIRCASE



PWD HOLDING POINT



PASSENGER LIFT



HANDICAP TOILET



DIAGRAM C [LEVEL 2]

TO GRAND BALLROOM

1. Take the ramp from the entrance of the Recreation Complex to passenger lift 1 or 2. Go up to level 2.
2. Walk across the pre-function lobby.

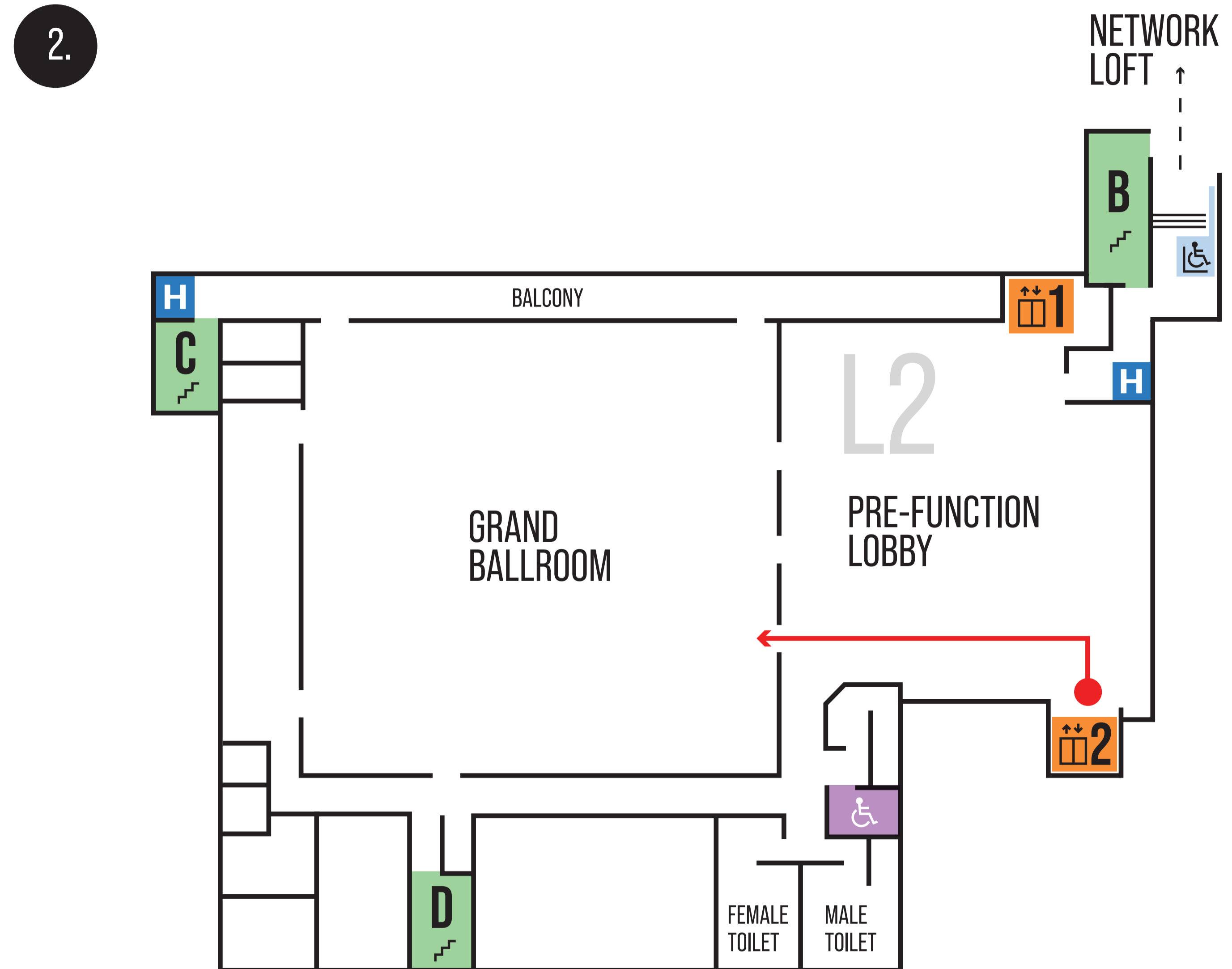
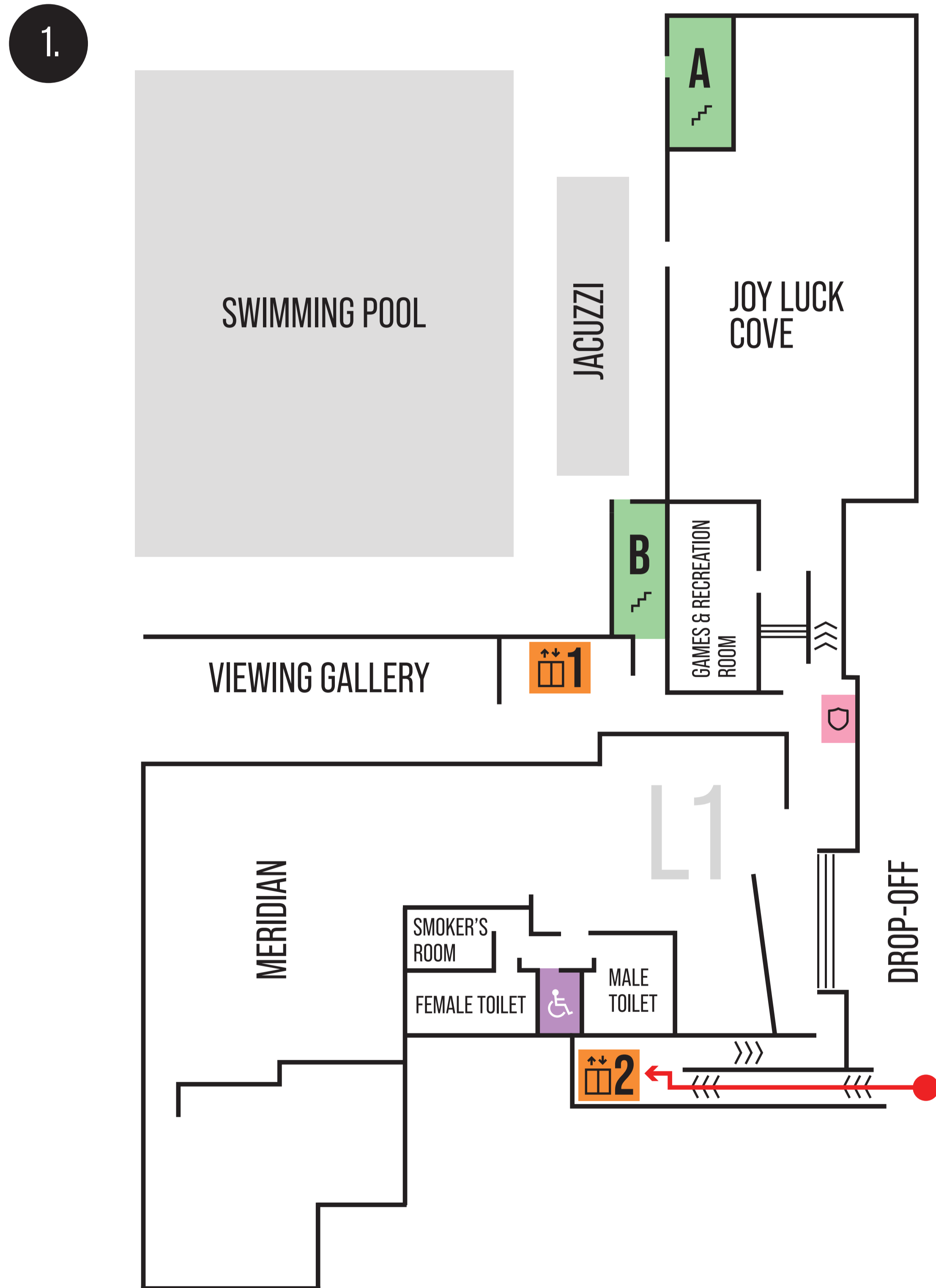

LEGEND :

ROUTE TO GRAND BALLROOM



PWD HOLDING POINT



STAIRCASE



WHEELCHAIR LIFT



PASSENGER LIFT



HANDICAP TOILET



DIAGRAM D [LEVEL 2M]

TO KARAOKE ROOM

1. Take the ramp from the entrance of the Recreation Complex to passenger lift 1. Go up to level 3.
2. Head to the Platform Lift  and press the call button for assistance.

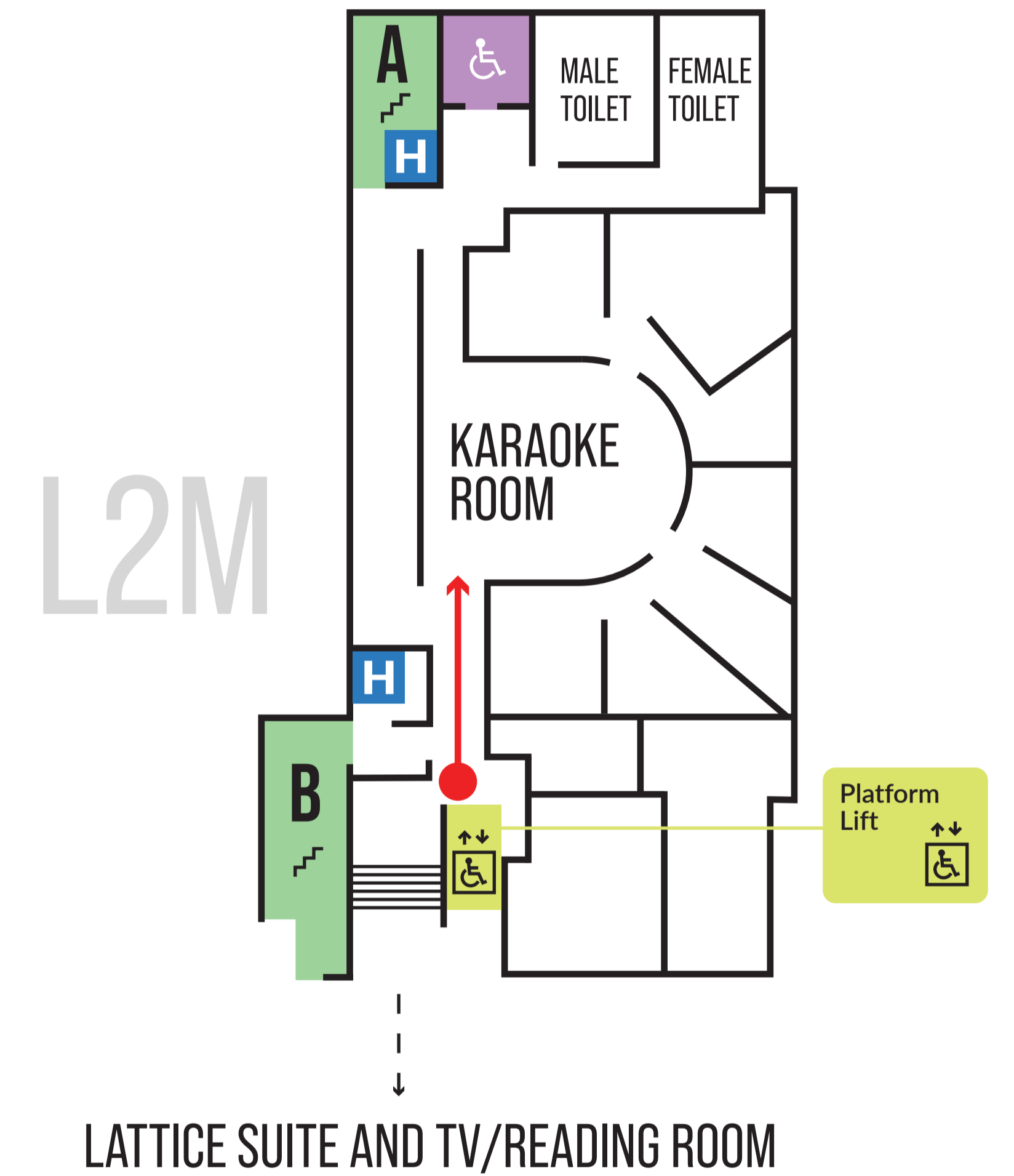
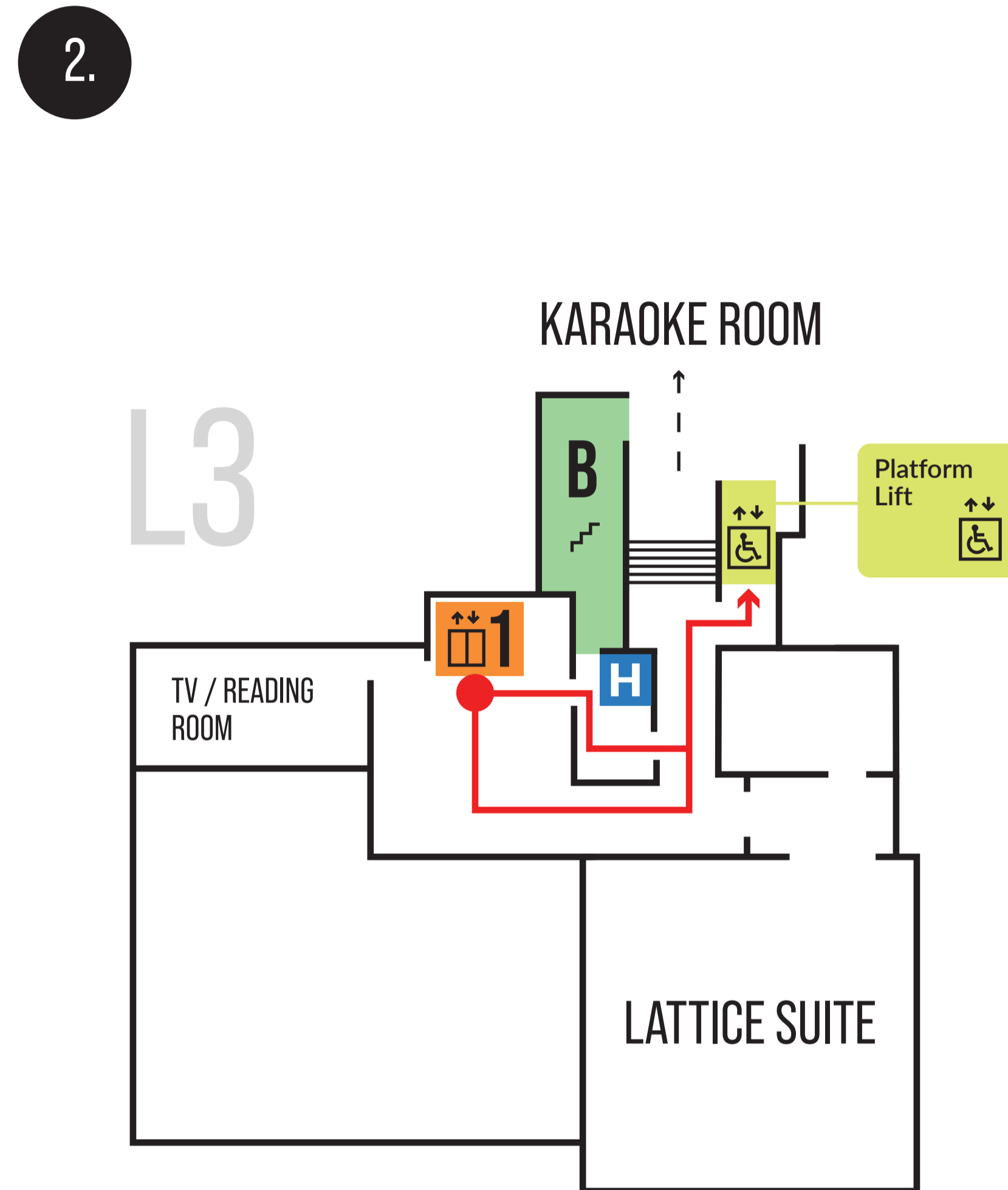
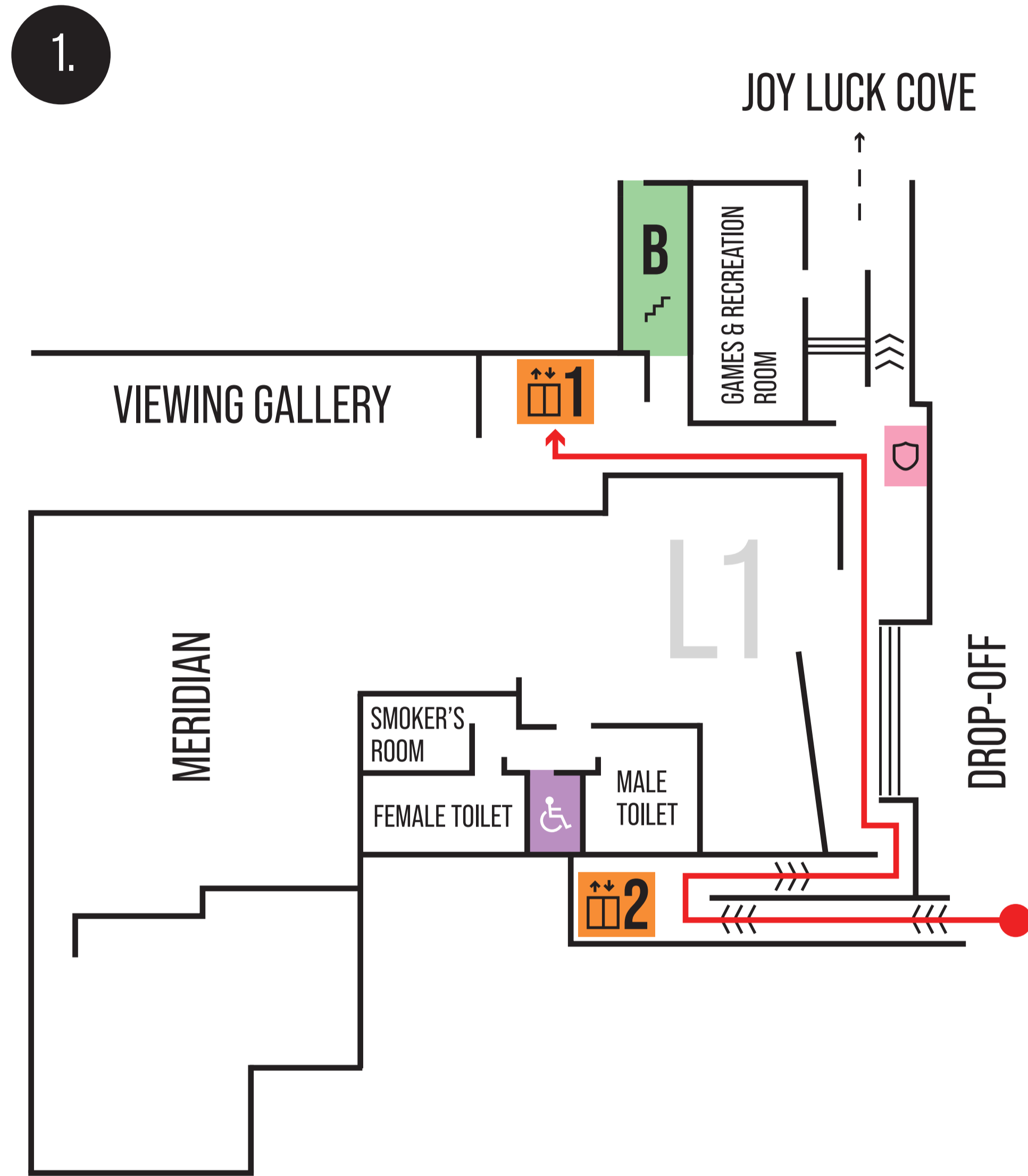

LEGEND :

ROUTE TO
KARAOKE ROOM



SECURITY COUNTER

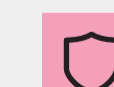

PLATFORM LIFT



STAIRCASE



PWD HOLDING POINT



PASSENGER LIFT



HANDICAP TOILET

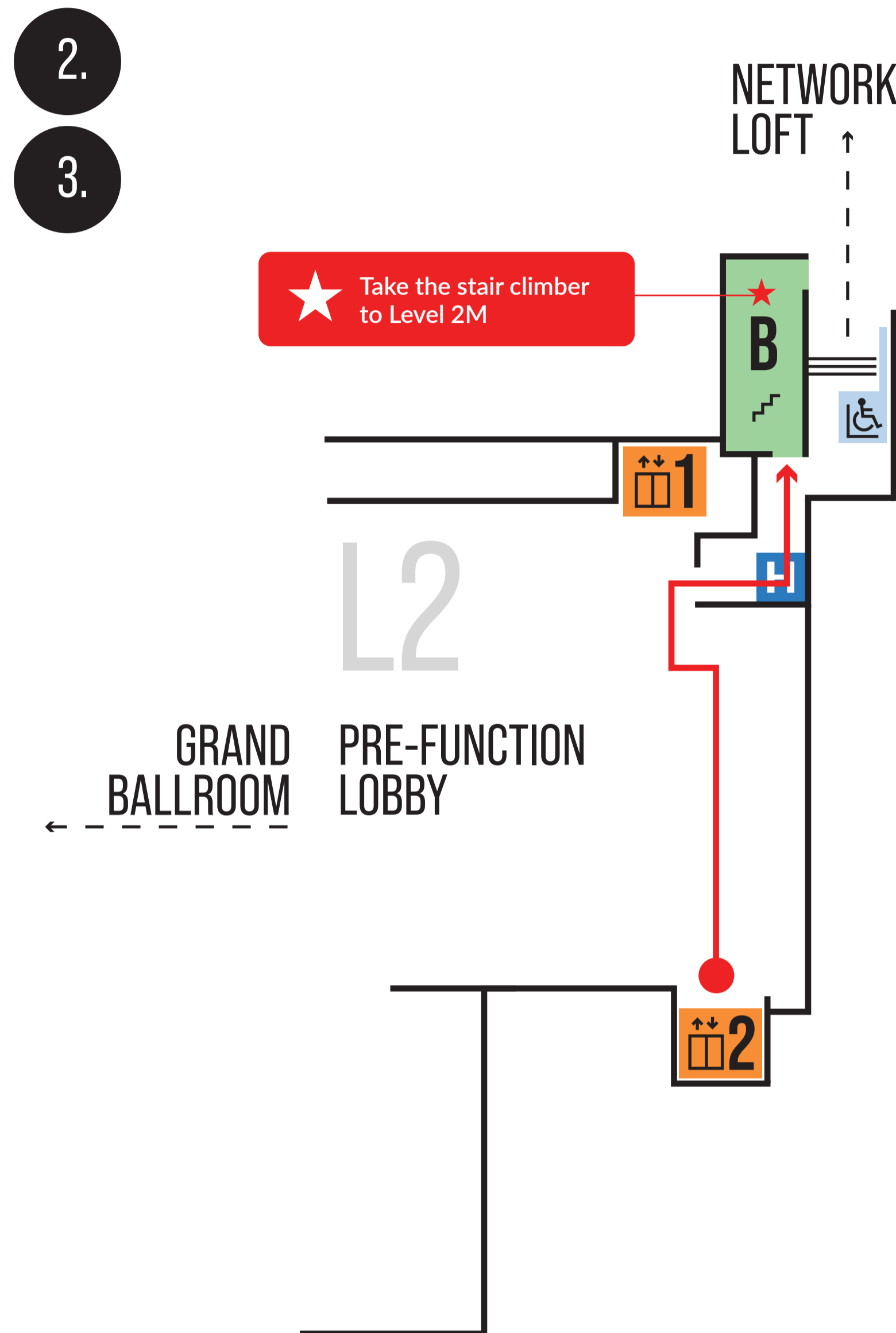
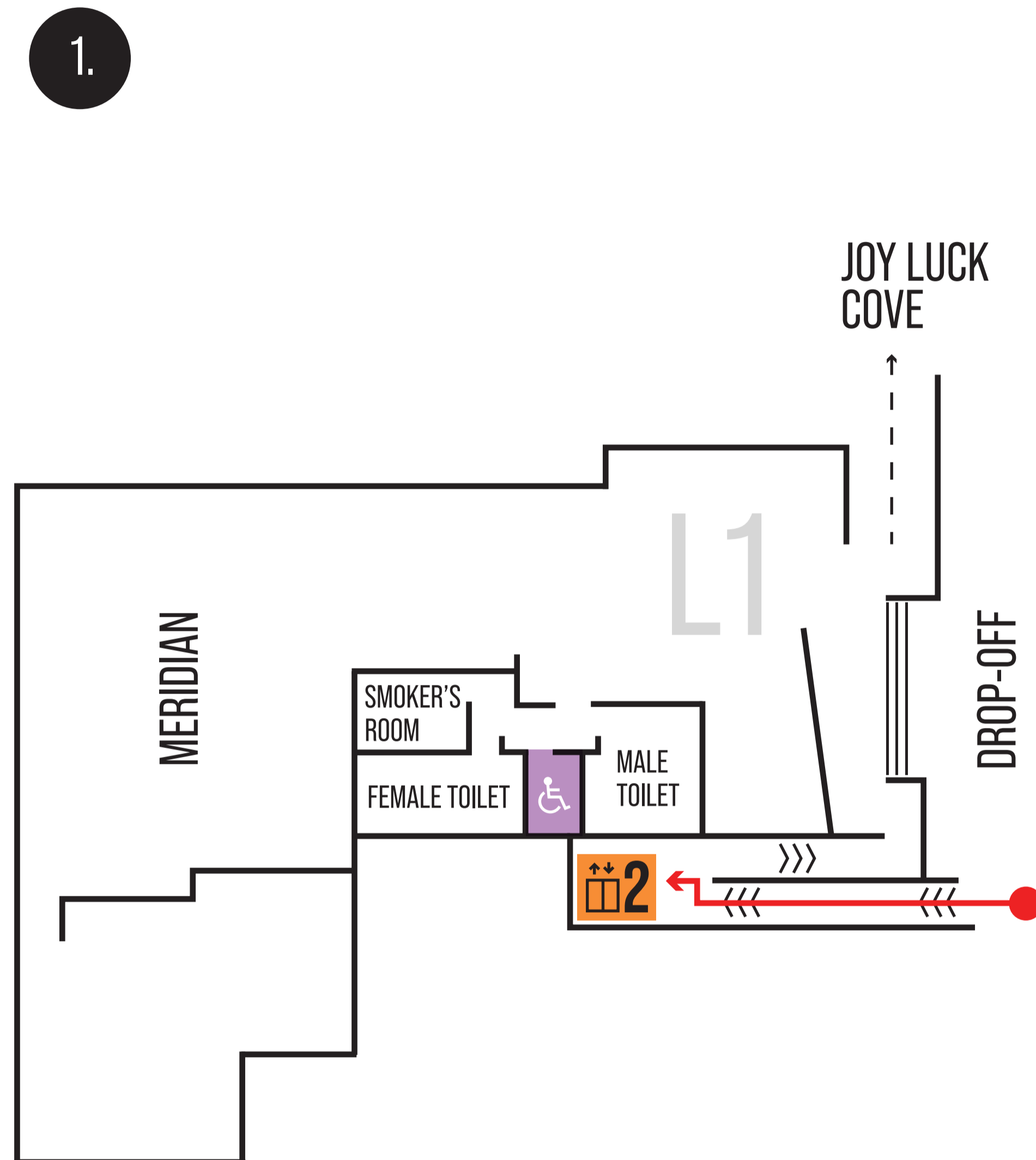

DIAGRAM D1 (LEVEL 2M)

TO KARAOKE ROOM

In the event Passenger Lift 1 is not available

1. Take the ramp from the entrance of the Recreation Complex to passenger lift 2. Go up to level 2.
2. Walk across the pre-function lobby.
3. Turn right and enter through the door. Head to staircase B. You will see the holding point with a call button. Press it and wait for assistance.
4. Take the stair climber ★ up to the Karaoke Room (Level 2M).



LEGEND :

ROUTE TO KARAOKE ROOM



PWD HOLDING POINT



PLATFORM LIFT



STAIRCASE



WHEELCHAIR LIFT



STAIR CLIMBER



PASSENGER LIFT



HANDICAP TOILET

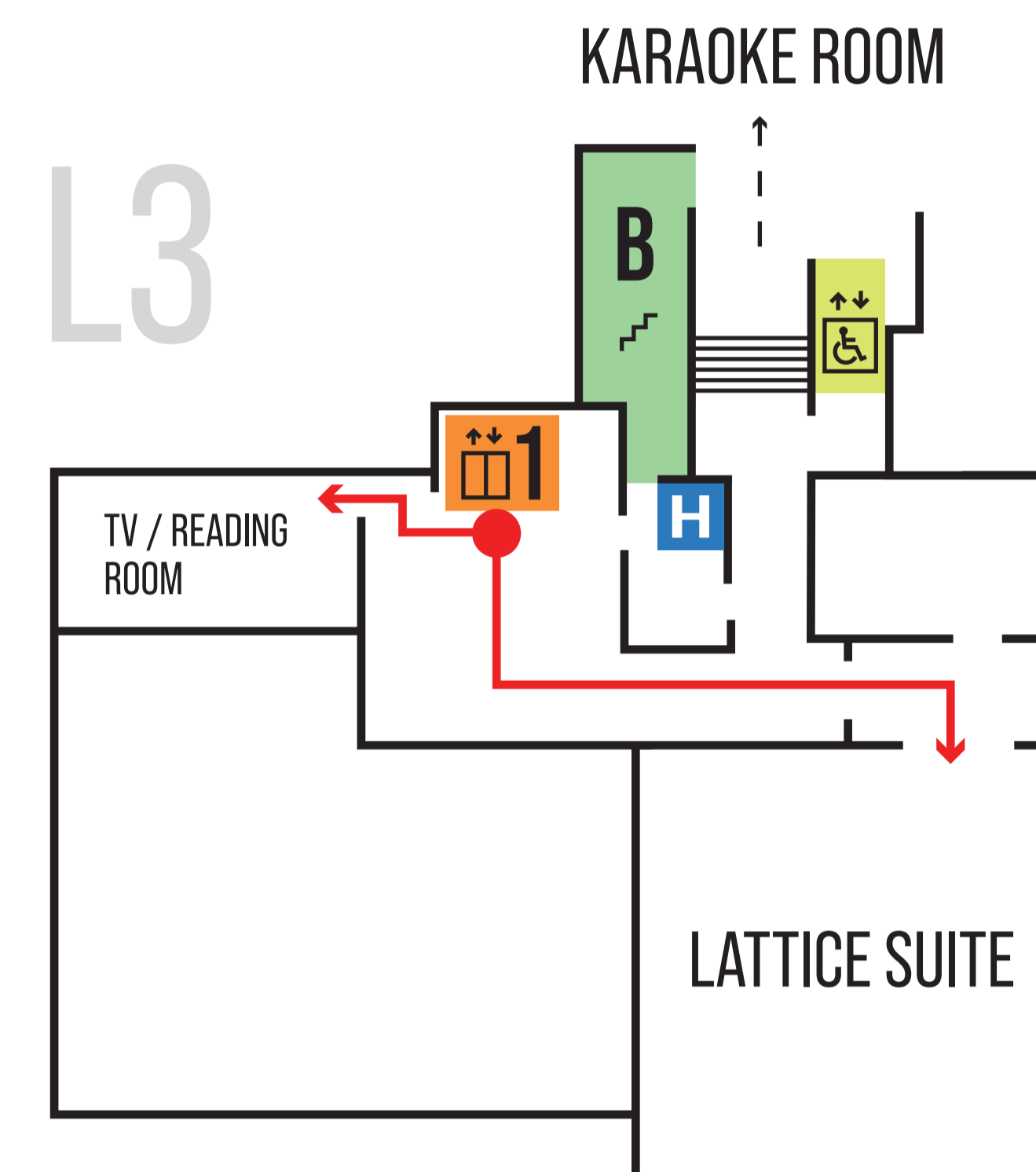
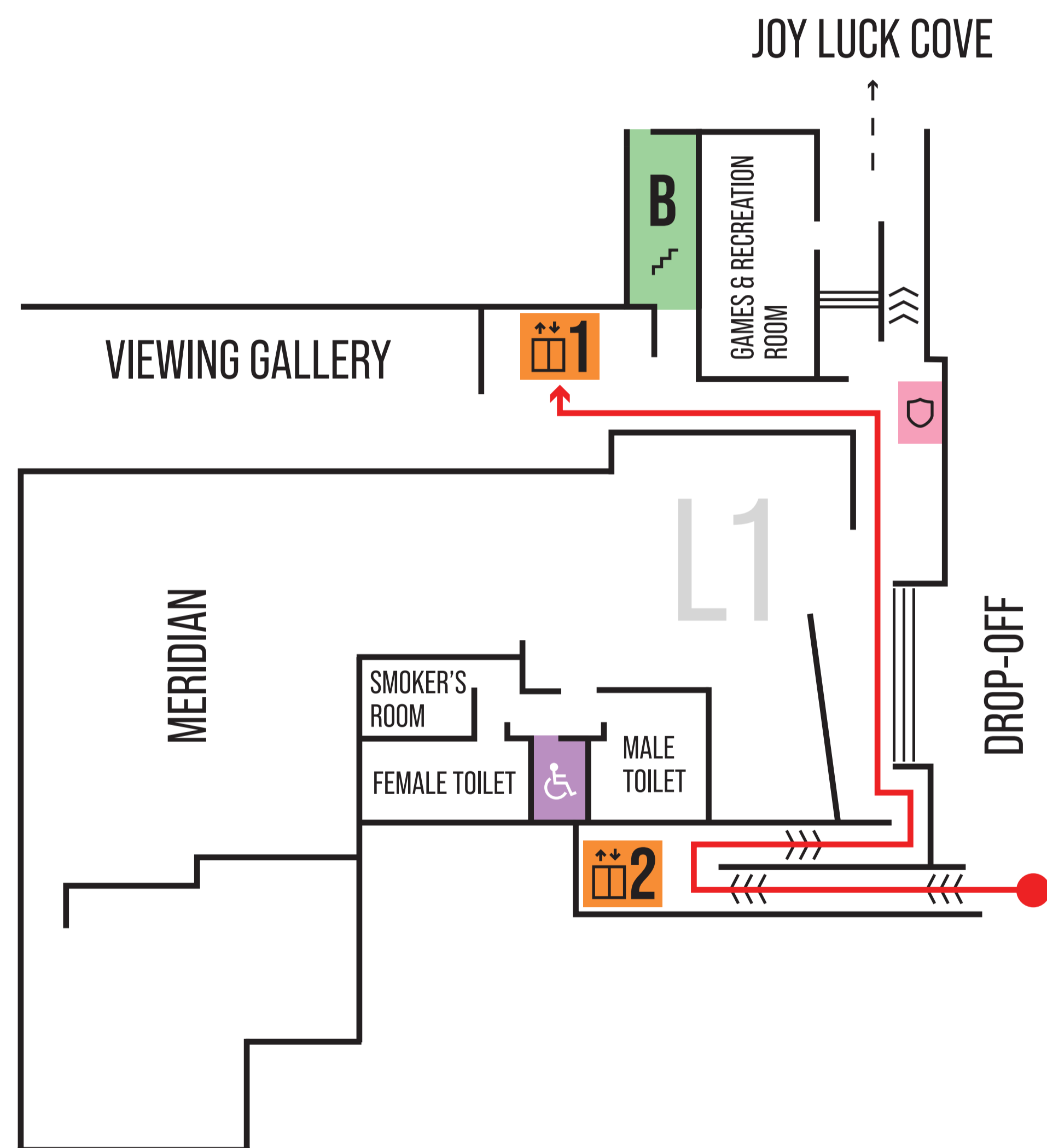

DIAGRAM E (LEVEL 3)

TO HERITAGE GALLERY, LATTICE SUITE AND TV/READING ROOM

1. Take the ramp from the entrance of the Recreation Complex to passenger lift 1. Go up to level 3.

1.



LEGEND :

ROUTE TO HERITAGE GALLERY
LATTICE SUITE AND TV/READING ROOM



PWD HOLDING POINT



STAIRCASE



PLATFORM LIFT



PASSENGER LIFT



HANDICAP TOILET



DIAGRAM E1 (LEVEL 3)

TO HERITAGE GALLERY, LATTICE SUITE AND TV/READING ROOM
In the event Passenger Lift 1 is not available

1. Take the ramp from the entrance of the Recreation Complex to passenger lift 2. Go up to level 2.
2. Walk across the pre-function lobby.
3. Turn right and enter through the door. Head to staircase B. You will see the holding point with a call button. Press it and wait for assistance.
4. Take the stair climber ★ up to Karaoke Room (Level 2M).
5. Take the platform lift 🚿 to the Lattice Suite and TV/Reading Room (Level 3)

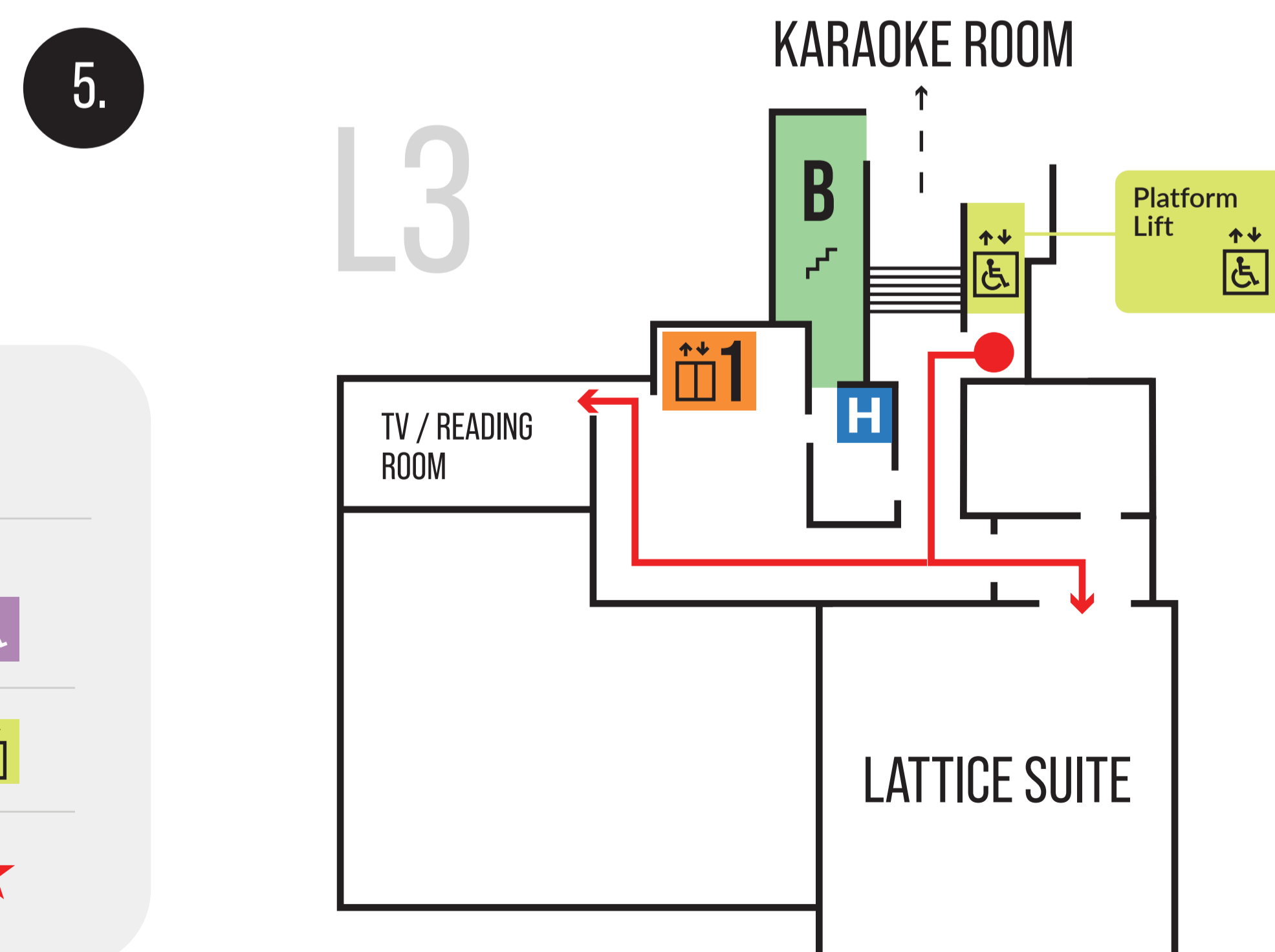
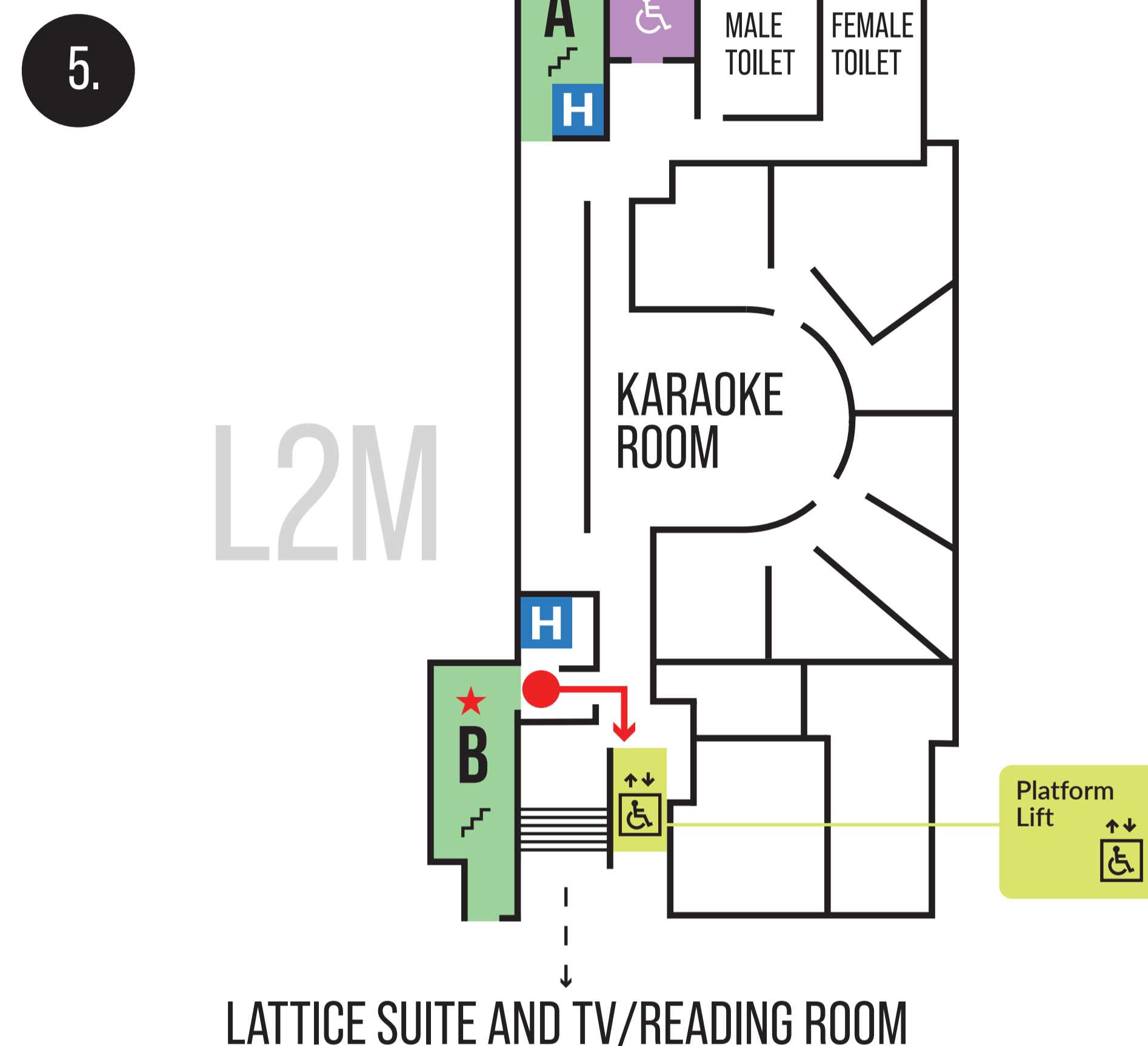
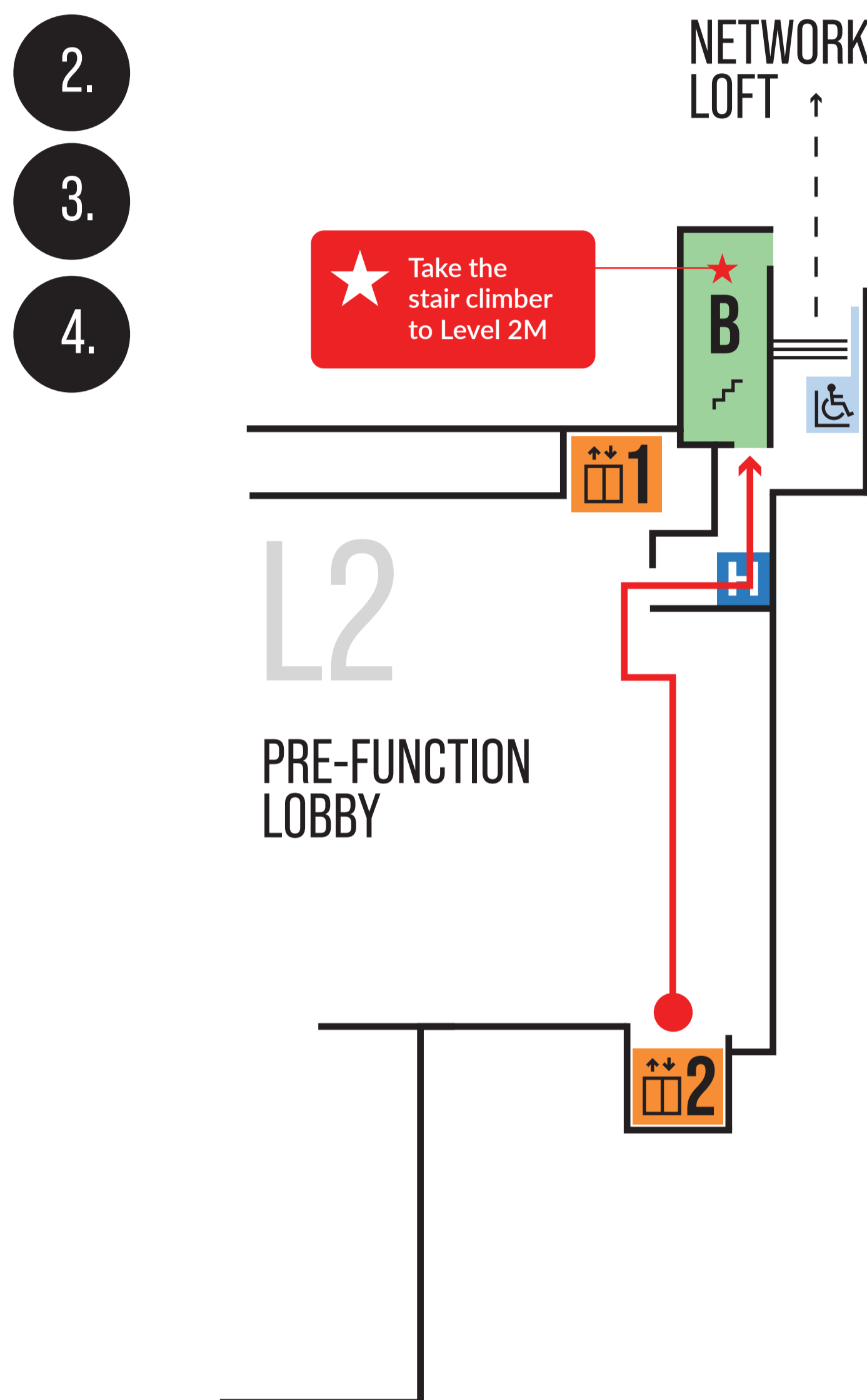
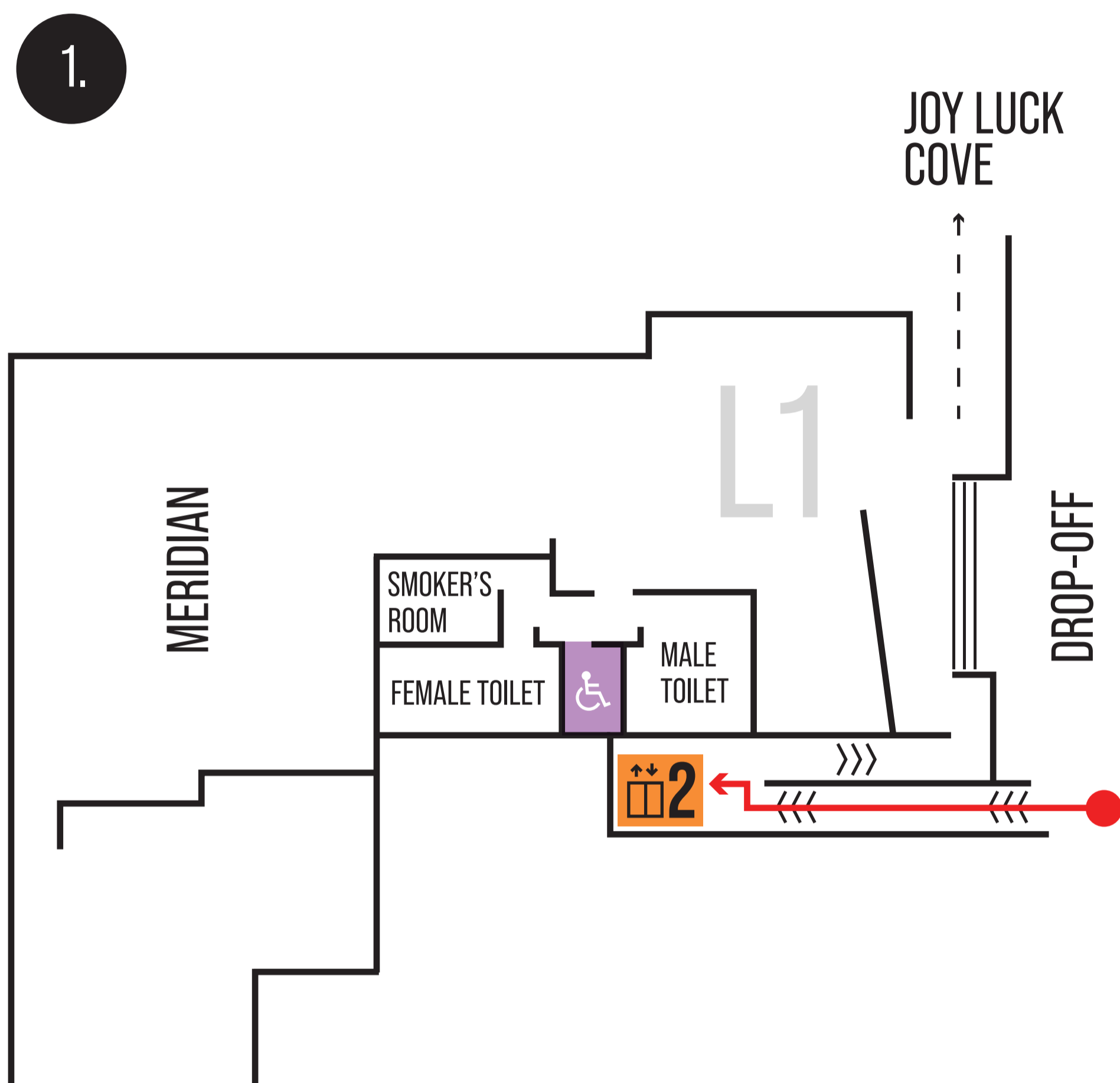

LEGEND:

ROUTE TO HERITAGE GALLERY, LATTICE SUITE & TV/READING ROOM



PASSENGER LIFT



HANDICAP TOILET



PWD HOLDING POINT



PLATFORM LIFT



STAIRCASE



WHEELCHAIR LIFT



STAIR CLIMBER

